

Washing station PROWASH CA PISTOPLAV

Service / Site : QUAL / France
Référence : 0012
Version : V.03.1
Date version : 19/02/2016
Page : 1/9

USER GUIDE



A Filter gasket assembly.

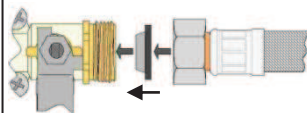

IMPORTANT !
Respect filter gasket orientation

B Tips assembly

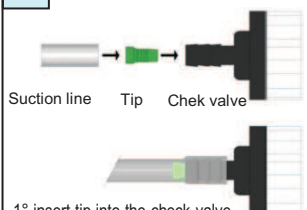

1° insert tip into the check valve.
2° insert suction line on the check valve (and tip).

C Blue hose assembly

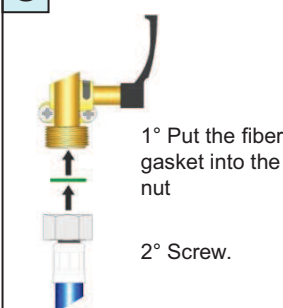

1° Put the fiber gasket into the nut

2° Screw.

D Gun assembly.

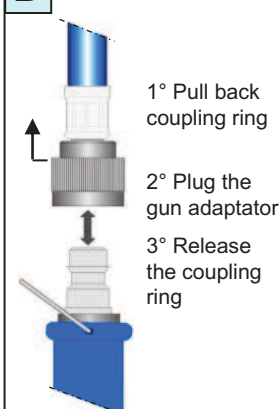

1° Pull back coupling ring

2° Plug the gun adaptor

3° Release the coupling ring

Washing station PROWASH.CA

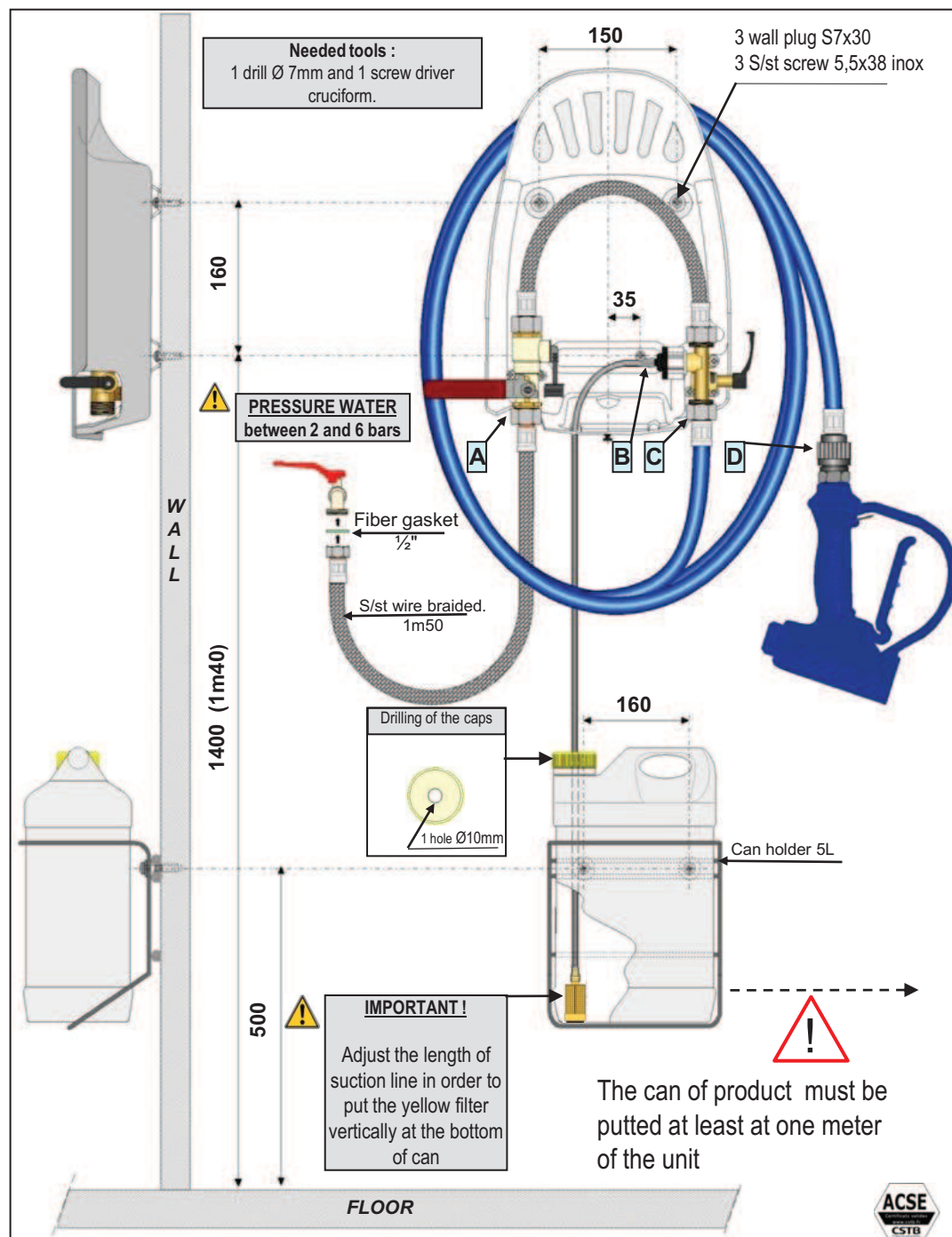

These installation dimensions are indicative

PACKING LIST - PROWASH UNIT

1 Hygiene Unit PROWASH (1 or 2 products)	1 connection kit	1 (2) Suction line L=2m.
1 Stainless steel wire braided hose. F1/2 - F3/4 L= 1,5m		1 (2) Foot filter with weight.
1 Discharge hose with conneciton L= 10, 15, 20 or 25 m (depends on modell)		1 (2) Bag with 15 metering tips.
1 Blue Spray gun		1 Green injector.
1 or 2 can holders 5 litres (depends on modell)	1 kit with screw and o' rings.	1 Strainer washer 3/4".
1 Technical data sheet		2 fibre gaskets 1/2".
Dimensions of the box (L x l x h) : 450 x 390 x 290 mm		2 fibre gaskets 3/4".
Weight unit (hose 10m) = 7 Kg		5 (7) st/st screws. Ø 5,5 x 37.
Weight unit (hose 15m) = 8,3 Kg		5 (7) Plastic plug type : S7.
Weight unit (hose 20m) = 9,5 Kg		2 (4) st/st washer type : L5
Weight unit (hose 25m) = 10,5 Kg		

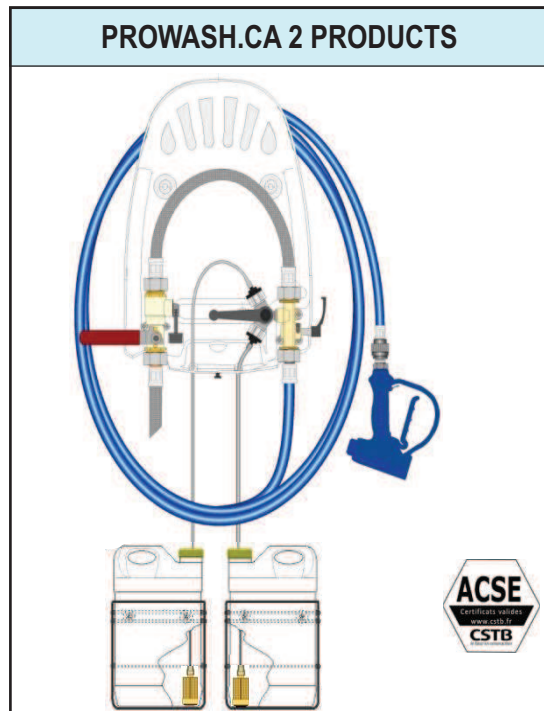
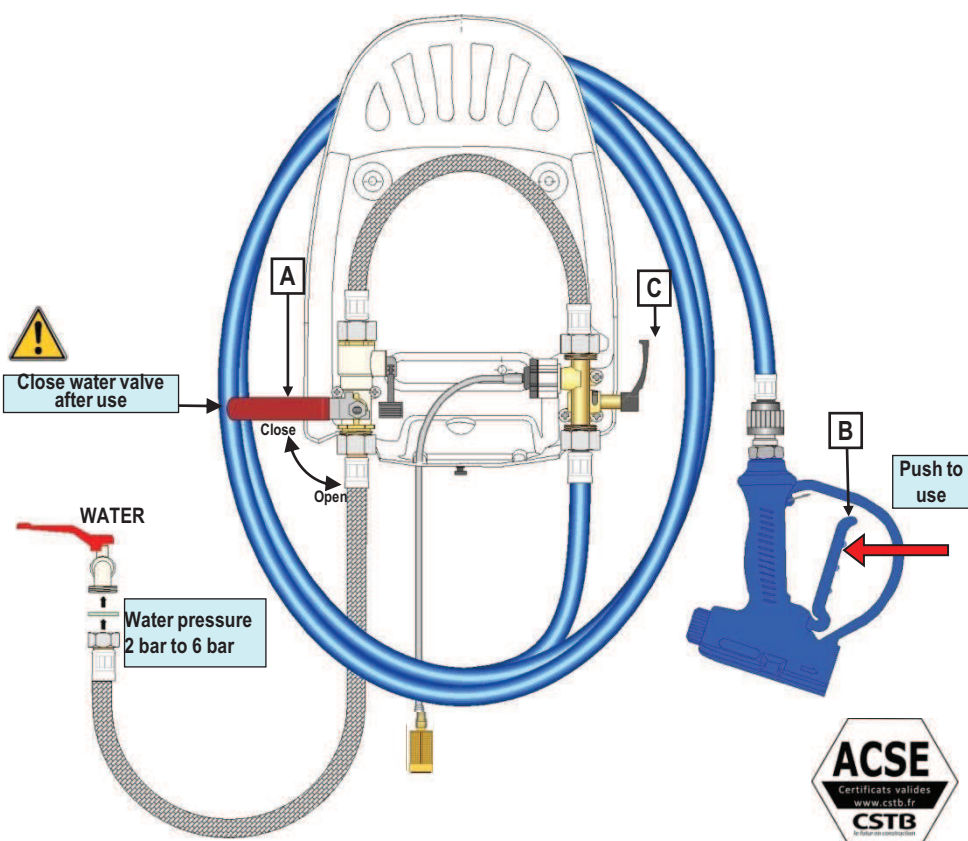

USE

- 1) Open water inlet valve "A"
- 2) Put down handle "C" to select "WASHING" mode.
- 3) Choose between product 1 or 2 (only with 2 products unit).
- 4) Push on gun trigger "B".
- 5) Wait few second for filling the suction line.
- 6) Spray.
- 7) Put up handle "C" on "RINSING" mode.
- 8) Rinse.
- 9) Shut-off water inlet valve "A" after use.



METHOD OF DILUTION CALCULATING

EXAMPLE: $\left(\frac{15 (A)}{1000 (B)} \right) \times 100\% = 1.5\%$

(this drawing is an exemple)

Volume A
(15 cl ou 150 ml)

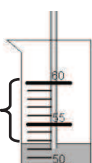

Volume A : sucked product

Volume B : solution (water + product)

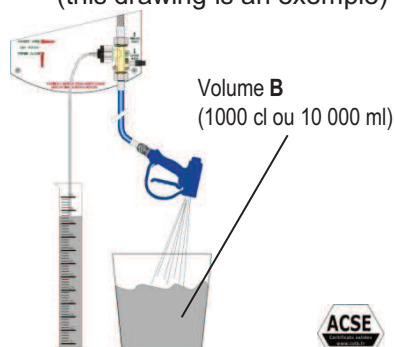

CAUTION

- ⚠ **ALWAYS** orientate spray in direction of surfaces to treat.
- ⚠ **NEVER** orientate spray in direction of people, animals or plants
- ⚠ **ALWAYS** wait few seconds for a good product and water mixing.
- ⚠ **ALWAYS** close water inlet valve after each use.
- ⚠ **WATER PRESSURE** must be included on 2 bar to 6 bar.
- ⚠ **MAXIMUM** working temperature is 50°C
- ⚠ **ALWAYS** keep the unit on frost protection

Dilution table for "PROWASH" unit

Pink	0,50%	Blue	5,00%
Purple	0,80%	White	6,80%
Turquoise	1,00%	Red	8,60%
Yellow	1,80%	beige	10,50%
Dark brown	1,50%	Black	10,80%
Orange	2,60%	Grey	10,90%
Green	3,20%	Without tip	11,00%
Brown light	3,30%	Transparent	

This table is done to help you to choose a tip according to expected concentration.



Conditions tests:

20m hose + blue gun
Green venturi injector
Dynamic water pressure = 3 bars (cold water)

PROWASH.CA WITH S/ST COVER.



LOGOS

- 1 Open the water inlet valve
- 2 « Washing » mode valve
- 3 Spray (water + product)
- 4 « Rinsing » mode valve
- 5 Spray (water)
- 6 Close the water inlet valve



Notice of Sanitary Comfurity
Equipment



N° 12 04 003

INSTALLATION PROWASH.CA WITH DRUM

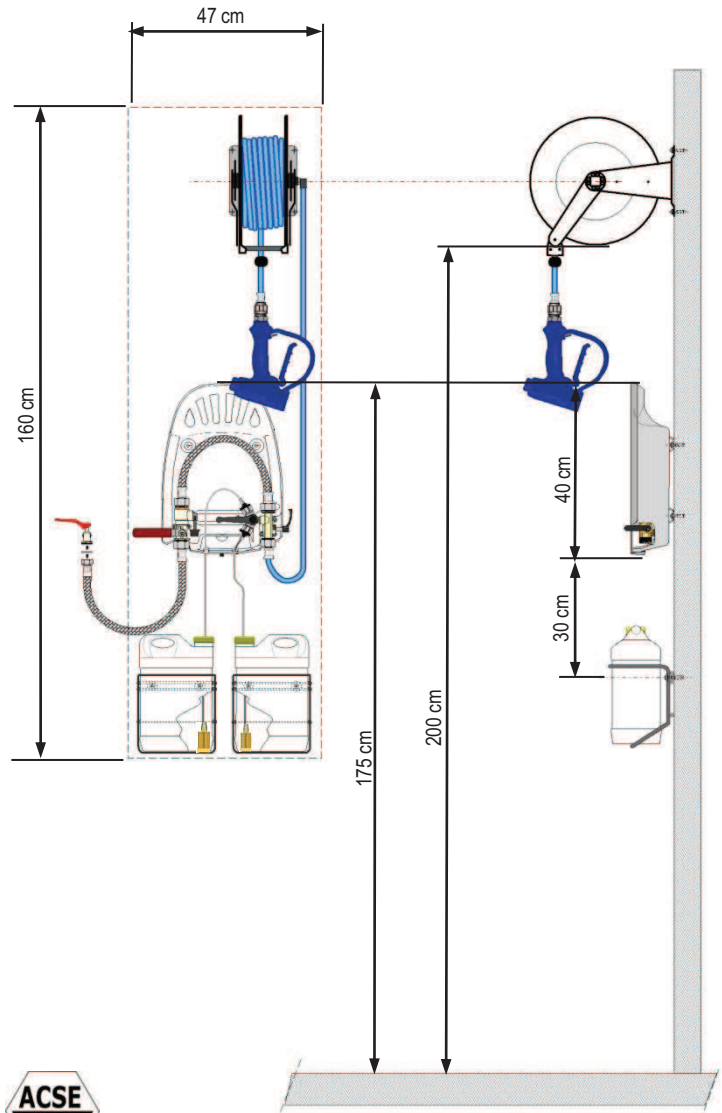

These dimensions of installation are indicative

TROUBLES

The unit doesn't suck up product

- 1° Check if water pressure is ok (minimum : 2 bars, maximum : 6 bars)
- 2° Check if filter gasket is clean. (clean or replace)
- 3° Check if the suction line is correctly in the can, and if pipe is not bended or blocked
- 4° Check if tip is not blocked (clean or replace)
- 5° Check if yellow filter is clean (clean or replace)
- 6° Check if spraying gun is clean (clean or replace)

Can product fills with water.

- 7° Check if check-valve is clean (clean or replace)



CLEANING or REPLACEMENT of green injector

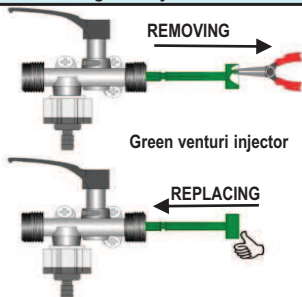

CLEANING of check-valve

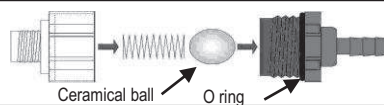

CLEANING or REPLACEMENT of filter gasket

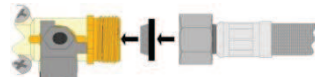

- 1_ Take off the nut of the s/st braided hose
- 2_ Clean or replace the filter gasket, respect the orientation.

CLEANING or REPLACEMENT of filter gasket

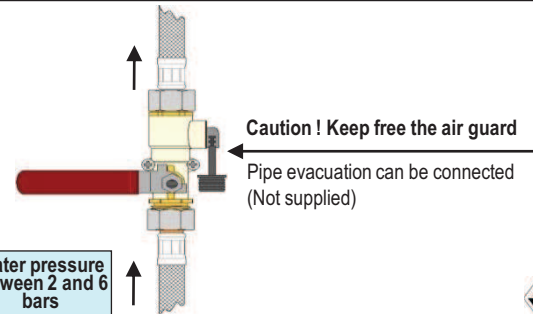

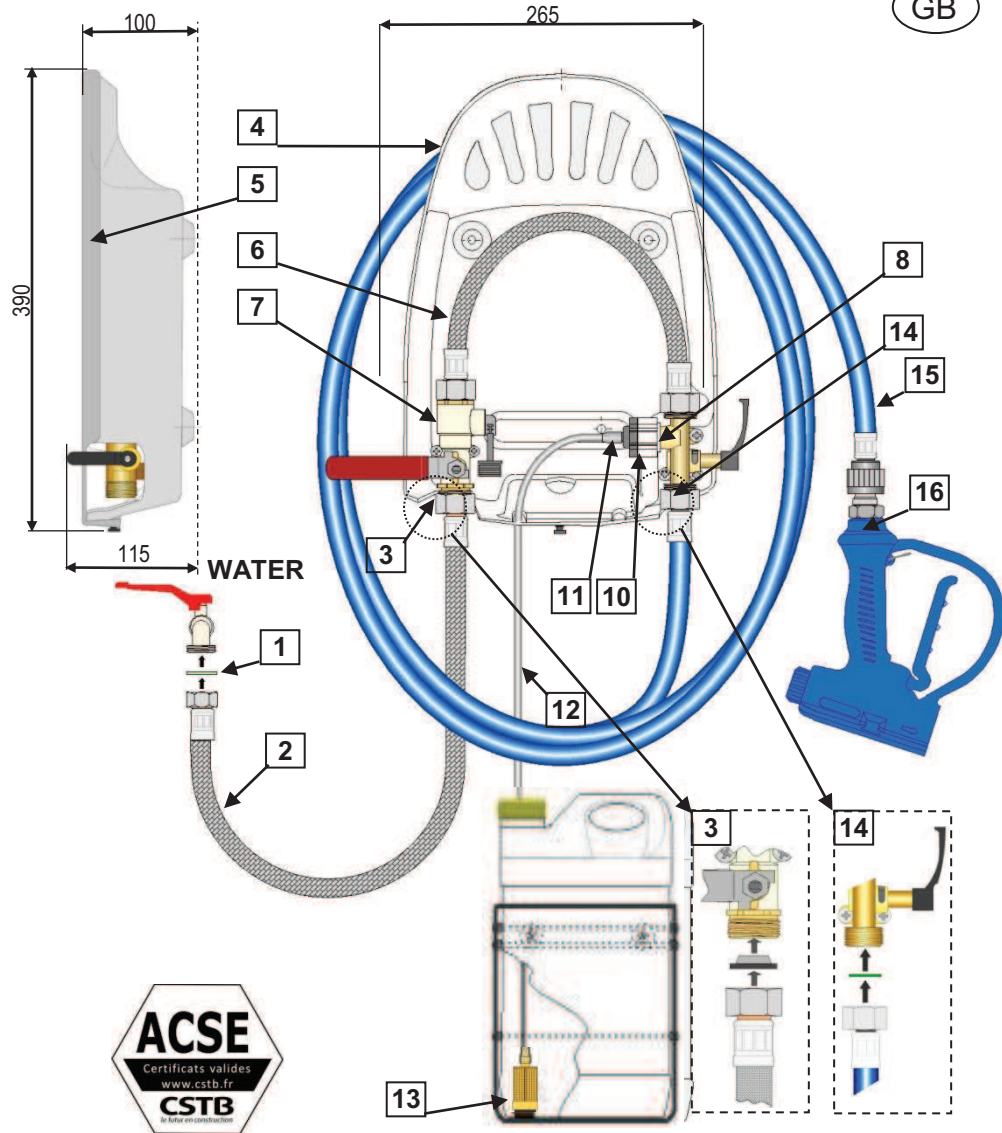
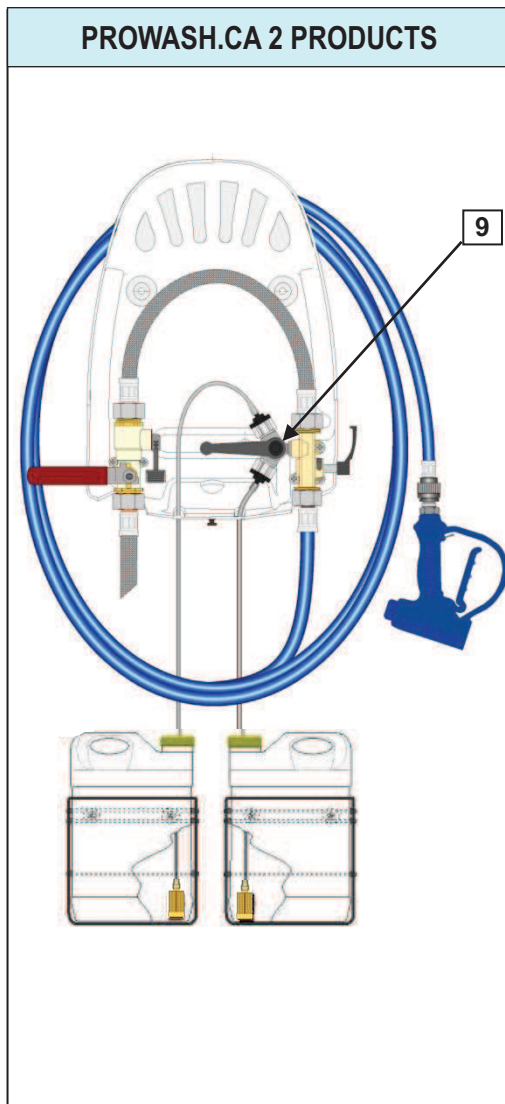

PROWASH unit is manufactured for cleaning and disinfection of floors and surfaces.



ACCESSORIES AND SPARE PARTS PROWASH.CA

Designation	Repère	
Fiber gasket 1/2"	1	
S/ST Braided hose F1/2 x F3/4 Lg: 1,5m	2	
Filter gasket 3/4"	3	
Back plate for unit 1 or 2 products (PVC)	4	
Screen printed cover 1 Product (PVC)	5	
Screen printed cover 2 Product (PVC)	5	
S/St Wire braided hose FF 3/4 L: 0,4 m	6	
Ball valve CA elbow air guard	7	
Venturi 1p+check valve+green injector+gasket EPDM	8	
Venturi 2p+check valve+green injector+gasket EPDM	9	
Check valve (EPDM)	10	
Dilution tip (bag of 15pieces)	11	
suction line Lg: 2m	12	
Yellow filter with integrated weight	13	
Fiber gasket 3/4"	14	
10m, 15m, 20m or 25m blue hose equipped	15	
Equipped blue gun with quick coupler	16	

Screen printed cover PROWASH 1 Product



Screen printed cover PROWASH 2 Products



N° DE CERTIFICAT

ACSE

Prowash CA Unit

12/04-003